

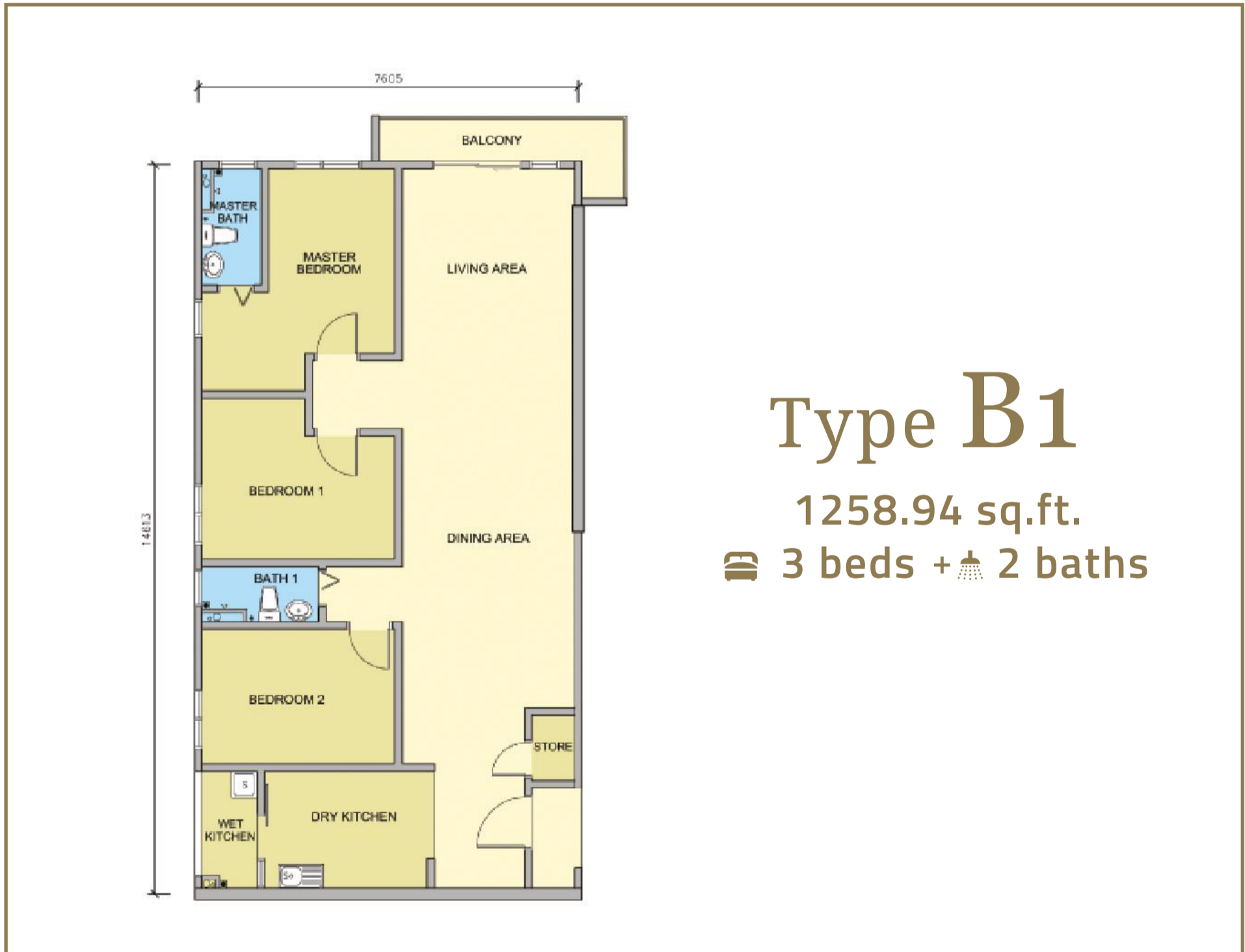

MAPLE RESIDENCES



UNIT TYPE



Specifications

Structure	Reinforced Concrete Frame	Floor Finishes	Bedrooms & Utility	Tiles	Sanitary	Kitchen Sink c/w Tap	2 nos	2 nos
Wall	Concrete / Brick (Where Applicable)	Kitchen	Tiles	Tiles	Installation	Bib Tap	3 nos	3 nos
Roofing	Concrete / Metal Deck (Where Applicable)	Balcony	Tiles	Tiles		Shower Rose	2 nos	2 nos
Ceiling	Generally Skim Coat & Paint / Plaster Ceiling (Where Applicable)	Bathrooms & Store	Tiles	Plastered / Skim Coat & Paint	Electrical	13 Amp Socket Outlet	13 nos	17 nos
Windows	Aluminium Frame Window	Internal	Plastered / Skim Coat & Paint	Wall Tiles Up To 1500mm Height	Installation	SMATV Point	1 nos	2 nos
Doors	Main Entrance	Bathrooms	With Plaster & Paint Above	With Plaster & Paint Above		Ceiling Fan Point	4 nos	5 nos
	Bedrooms	Kitchen	Wall Tiles Up To 1500mm Height	With Plaster & Paint Above		Wall Fan Point	1 nos	-
	Kitchen & Utility		With Plaster & Paint Above	Type A		Lighting Point	18 nos	21 nos
	Bathrooms		Type B	2 nos		Telephone Point	1 nos	1 nos
	Store		2 nos	2 nos		A/C Point	4 nos	5 nos
Ironmongery	Quality Lockset	Sanitary	2 nos	2 nos	Installation	Water Heater Point	2 nos	2 nos
Floor Finishes	Living & Dining	Installation	2 nos	2 nos		Door Bell Point	1 nos	1 nos