

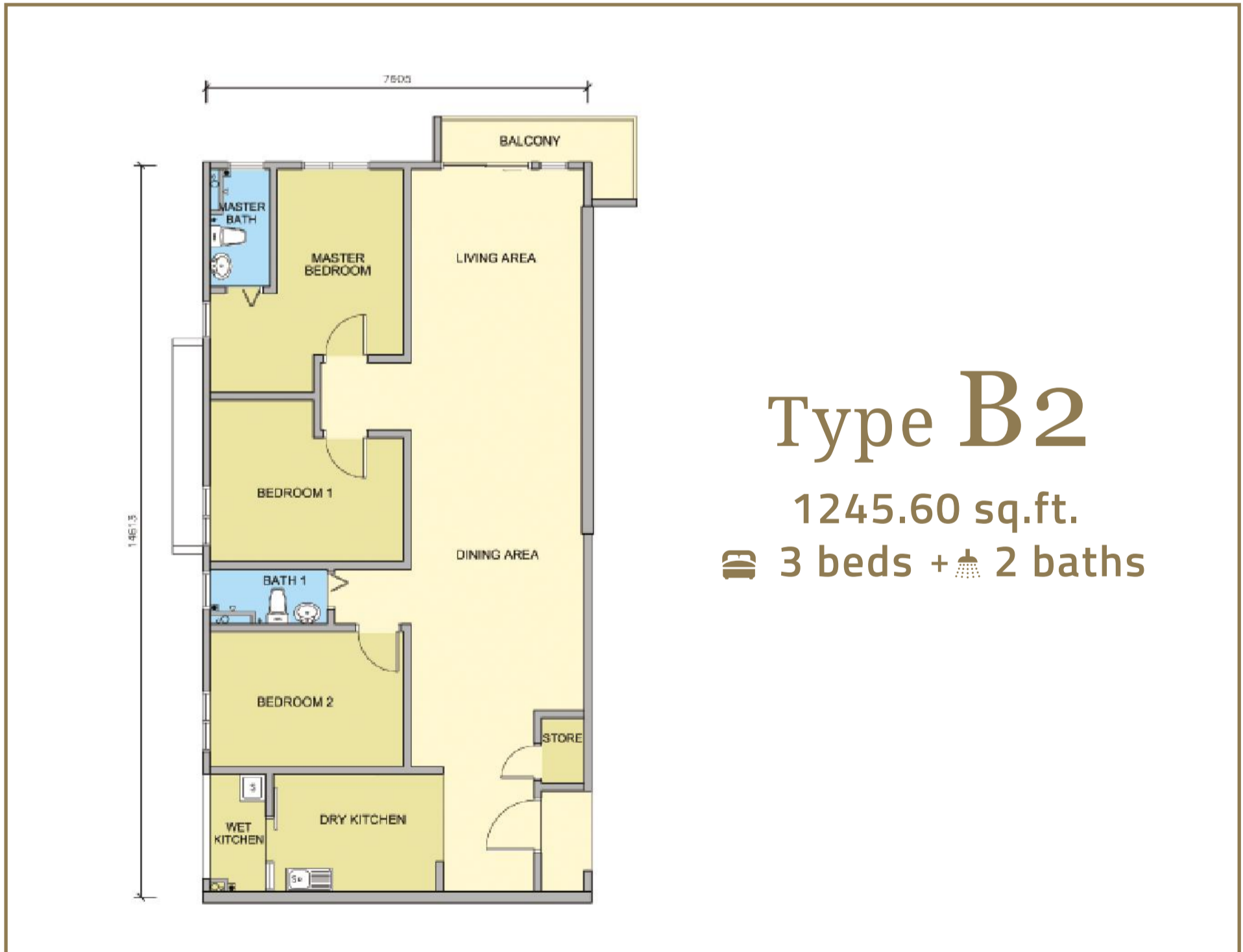

MAPLE RESIDENCES



UNIT TYPE



Developer License No: 3390-55/07-2017/0675(L) (Validity: 30-7-2015 to 29-7-2017) • Advertisement Permit No: 3390-55/07-2017/0675(P) (Validity: 30-7-2015 to 29-7-2017) • Developer: Khoo Soon Lee Realty Sdn Bhd (66384-P) No. 2, Jalan Langkat K59, Bandar Bestari, 42000 Klang, Selangor, Malaysia. Telephone: 03-3122 8268 • Land Tenure: Freehold • Land Encumbrances: RHB Bank Berhad • Approval Authority: Majlis Perbandaran Klang • Building Plan Approval No: MPK/BGN-600-4/1/191(2014) • Completion Date: June 2018 • Type of Property: Serviced Apartments • Total No. of Units: 576 units • Block A: 192 units, (Min) RM 512,380.00 - (Max) RM 802,780.00 • Block B: 192 units, (Min) RM 532,180.00 - (Max) RM 845,680.00 • Block C: 192 units, (Min) RM 561,880.00 - (Max) RM 859,680.00. All information contained herein is subject to changes as may be required by the relevant authorities without any notification and shall not be binding or be deemed to form a contract or any part thereof. Whilst every care has been taken in providing this information, we, Khoo Soon Lee Realty Sdn Bhd shall not be held liable for any claim whatsoever arising from the use and/or reliance on the above information. All illustrations and pictures are artist impressions only, no representation or warranty is made as to the accuracy or completeness of the same. The item are subject to variation, modifications and substitutions as may be recommended by the relevant authorities or consultants.

Specifications

Structure	Reinforced Concrete Frame	Floor Finishes	Bedrooms & Utility Kitchen Balcony Bathrooms & Store	Tiles Tiles Tiles Tiles	Sanitary Installation	Kitchen Sink c/w Tap Bib Tap Shower Rose	2 nos 3 nos 2 nos	2 nos 3 nos 2 nos
Wall	Concrete / Brick (Where Applicable)	Wall	Internal Bathrooms	Plastered / Skim Coat & Paint Wall Tiles Up To 1500mm Height With Plaster & Paint Above	Electrical Installation	13 Amp Socket Outlet SMATV Point Ceiling Fan Point Wall Fan Point Lighting Point Telephone Point A/C Point Water Heater Point Door Bell Point	13 nos 1 nos 4 nos 1 nos 18 nos 1 nos 4 nos 2 nos 1 nos	17 nos 2 nos 5 nos - 21 nos 1 nos 5 nos 2 nos 1 nos
Roofing	Concrete / Metal Deck (Where Applicable)	Doors	Kitchen	Wall Tiles Up To 1500mm Height With Plaster & Paint Above				
Ceiling	Generally Skim Coat & Paint / Plaster Ceiling (Where Applicable)	Bedrooms		Type A Type B				
Windows	Aluminium Frame Window	Kitchen & Utility		2 nos 2 nos				
Doors	Main Entrance Bedrooms Kitchen & Utility Bathrooms Store	Bathrooms		2 nos 2 nos				
Ironmongery	Quality Lockset	Kitchen		2 nos 2 nos				
Floor Finishes	Living & Dining	Sanitary Installation	Wash Basin c/w Tap Water Closet	2 nos 2 nos				