

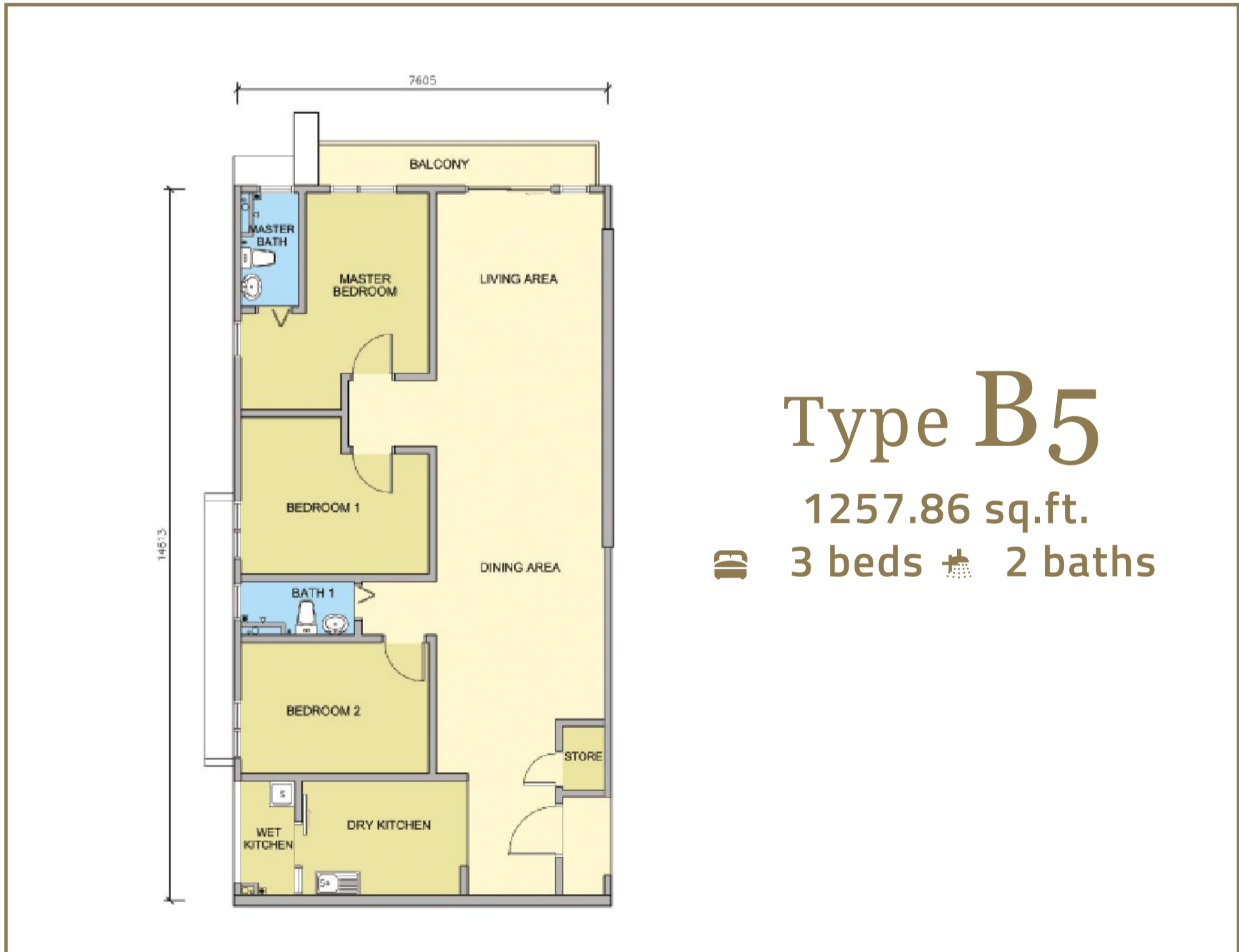

MAPLE RESIDENCES



UNIT TYPE



Developer License No: 3390-55/07-2017/0675(L) (Validity: 30-7-2015 to 29-7-2017) • Advertisement Permit No: 3390-55/07-2017/0675(P) (Validity: 30-7-2015 to 29-7-2017) • Developer: Khoo Soon Lee Realty Sdn Bhd (66384-P) No. 2, Jalan Langkat K59, Bandar Bestari, 42000 Klang, Selangor, Malaysia. Telephone: 03-3122 8268 • Land Tenure: Freehold • Land Encumbrances: RHB Bank Berhad • Approval Authority: Majlis Perbandaran Klang • Building Plan Approval No: MPK/BGN-600-4/1/191(2014) • Completion Date: June 2018 • Type of Property: Serviced Apartments • Total No. of Units: 576 units • Block A: 192 units, (Min) RM 512,380.00 - (Max) RM 802,780.00 • Block B: 192 units, (Min) RM 532,180.00 - (Max) RM 845,680.00 • Block C: 192 units, (Min) RM 561,880.00 - (Max) RM 859,680.00. All information contained herein is subject to changes as may be required by the relevant authorities without any notification and shall not be binding or be deemed to form a contract or any part thereof. Whilst every care has been taken in providing this information, we, Khoo Soon Lee Realty Sdn Bhd shall not be held liable for any claim whatsoever arising from the use and/or reliance on the above information. All illustrations and pictures are artist impressions only, no representation or warranty is made as to the accuracy or completeness of the same. The item is subject to variation, modifications and substitutions as may be recommended by the relevant authorities or consultants.

Specifications

Structure	Reinforced Concrete Frame	Floor Finishes	Bedrooms & Utility	Tiles	Sanitary	Kitchen Sink c/w Tap	2 nos	2 nos
Wall	Concrete / Brick (Where Applicable)	Kitchen	Tiles	Tiles	Installation	Bib Tap	3 nos	3 nos
Roofing	Concrete / Metal Deck (Where Applicable)	Balcony	Tiles	Tiles		Shower Rose	2 nos	2 nos
Ceiling	Generally Skim Coat & Paint / Plaster Ceiling (Where Applicable)	Bathrooms & Store	Tiles	Plastered / Skim Coat & Paint	Electrical	13 Amp Socket Outlet	13 nos	17 nos
Windows	Aluminium Frame Window	Internal	Plastered / Skim Coat & Paint	Wall Tiles Up To 1500mm Height	Installation	SMATV Point	1 nos	2 nos
Doors	Main Entrance	Bathrooms	Wall Tiles Up To 1500mm Height	With Plaster & Paint Above		Ceiling Fan Point	4 nos	5 nos
	Bedrooms	Kitchen	With Plaster & Paint Above	Wall Tiles Up To 1500mm Height		Wall Fan Point	1 nos	-
	Kitchen & Utility		With Plaster & Paint Above	With Plaster & Paint Above		Lighting Point	18 nos	21 nos
	Bathrooms		Type A	Type B		Telephone Point	1 nos	1 nos
	Store		2 nos	2 nos		A/C Point	4 nos	5 nos
Ironmongery	Quality Lockset	Sanitary	Installation	2 nos	2 nos	Water Heater Point	2 nos	2 nos
Floor Finishes	Living & Dining	Installation	Water Closet	2 nos	2 nos	Door Bell Point	1 nos	1 nos